

Loudspeakers and Accessories



Search

Home | Single Drivers / Accessories | Kits | Car-Hifi | High End | Industry | Public Address |

Single Drivers / Accessories

New products

Fullrange Systems

- B 200 6 OHM
- BF 45 4 OHM
- BG 13 P 8 OHM
- BG 17 8 OHM
- BG 20 8 OHM
- F 8 SC 8 OHM
- FR 10 4 OHM
- FR 10 8 OHM
- FR 10 F 4 OHM
- FR 10 HM 4 OHM
- FR 10 HM 8 OHM
- FR 10 WP 4 OHM (black)
- FR 10 WP 4 OHM (white)
- FR 10 WPX 4 OHM (black)
- FR 10 WPX 4 OHM (white)
- FR 12 4 OHM
- FR 12 8 OHM
- FR 13 4 OHM
- FR 13 WP 4 OHM (black)
- FR 13 WP 4 OHM (white)
- FR 16 WP 4 OHM (black)
- FR 16 WP 4 OHM (white)
- FR 16 WP CL 100 V
- FR 6,5" 8 OHM
- FR 7 4 OHM
- FR 8 4 OHM
- FR 87 4 OHM
- FR 8 8 OHM
- FR 8 JS 8 OHM
- FR 8 WP 4 OHM (black)
- FR 8 WP 4 OHM (white)
- FR 8 WP 8 OHM (black)
- FR 8 WP 8 OHM (white)
- FR 9.15 4 OHM
- FRS 10 WP 4 OHM (black)
- FRS 10 WP 4 OHM (white)
- FRS 10 WP 8 OHM (black)
- FRS 10 WP 8 OHM (white)
- FRS 5 8 OHM
- FRS 5 X 8 OHM
- FRS 7 4 OHM
- FRS 7 8 OHM
- FRS 7 S 8 OHM
- FRS 7 W 8 OHM
- FRS 8 4 OHM
- FRS 8 8 OHM
- FRS 8 M 8 OHM
- FRWS 5 4 OHM
- FRWS 5 8 OHM

R 10 SC 8 OHM

Art. No. 2041

Magnetically shielded 10 cm (4") fullrange speaker with high efficiency, balanced frequency response. Water-repellent cone and rubber gasket. Especially suitable as control speaker in electronic devices and as speaker for public applications and public transport systems.

Typical applications:

- Video monitoring screens
- Control speakers for electronic devices
- Ceiling-mounted speakers in railway carriages and busses

Attributes:

- functionally at cold according to EN 60068-2-1/EN 50155
- cold storage (-40 °C) according to EN 60068-2-1/EN 50155
- functionally at damp heat (cyclic) according to EN 60068-2-3/EN 50155
- functionally at dry heat according to EN 60068-2-2/EN 50155

*) IP protection class for front side when built into a sealed enclosure

Used in / Accessories:

- GRILLE 10 ES
- GRILLE 10 R/134
- GRILLE 10 RS
- GRILLE 10 PL

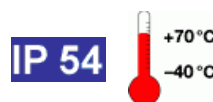
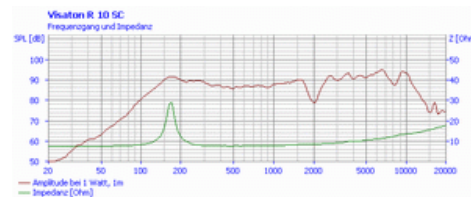
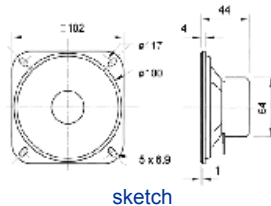

Technical Data:

| | |
|----------------------------|-----------------|
| Rated power | 20 W |
| Maximum power | 30 W |
| Nominal impedance Z | 8 Ohm |
| Frequency response | 100–13000 Hz |
| Mean sound pressure level | 90 dB (1 W/1 m) |
| Opening angle (-6 dB) | 92°/4000 Hz |
| Excursion limit | +/-1,5 mm |
| Resonance frequency fs | 150 Hz |
| Magnetic induction | 0,95 T |
| Magnetic flux | 135 µWb |
| Height of front pole-plate | 3 mm |
| Voice coil diameter | 15 mm |
| Height of winding | 4 m |
| Cutout diameter | 93 m |
| Net weight | 0,24 kg |
| D.C. resistance Rdc | 7,4 Ohm |
| Mechanical Q factor Qms | 5,3 |
| Electrical Q factor Qes | 2,63 |
| Total Q factor Qts | 1,76 |
| Equivalent volume Vas | 2,3 l |
| Effective piston area Sd | 56 cm² |

FRWS 5 R 8 OHM
 FRWS 5 SC 8 OHM
 K 50 8 OHM
 K 50 SQ 8 OHM
 K 50 WP 16 OHM
 K 50 WP 50 OHM
 K 50 WP 8 OHM
 K 57 C 8 OHM
 K 64 WP 50 OHM
 K 64 WP 8 OHM
 K 64 WPT 8 OHM
 R 10 S 4 OHM
 R 10 S 8 OHM
 R 10 SC 4 OHM
 R 10 SC 8 OHM
 SC 13 8 OHM
 SC 4.7 ND 4 OHM
 SC 4.7 ND 8 OHM
 SC 5.9 8 OHM
 SC 5.9 ND 4 OHM
 SC 5.9 ND 8 OHM
 SC 8 N 8 OHM
 SL 713 4 OHM
 SL 87 WPM 4 OHM
 SL 87 WPM 8 OHM
 SL 87 XA 8 OHM
 WS 13 E 8 OHM

Woofers

Bass Midranges
 Cone Midranges
 Dome Midranges
 Horn Midranges
 Ribbon Tweeter
 Dome Tweeters
 Horn Tweeters
 Cone Tweeters
 Coaxial Speakers
 Miniature Speakers
 Magnetically Shielded
 Speakers
 Waterproof Speakers
 Ceiling Speakers
 Re-Entrant Horn Speakers
 Slim Column Systems
 Cabinet-housed speakers
 PA Speakers
 Structure-borne drivers
 Crossovers
 Crossover Components
 Accessories
 Other Products
 Archive

| | |
|--------------------------------|--------------------------------------|
| Dynamically moved mass Mms | 2,2 g |
| Force factor Bxl | 2,4 T m |
| Inductance of the voice coil L | 0,5 mH |
| Connections | 5,2 x 0,5 mm (+) 2,8 x 0,5 mm (-) |
| Protective system | IP 54 *) |
| Temperature range | -40 ... 70 °C |

Similar Products

| | |
|----------------------------|----------------------------|
| FR 10 4 OHM | FR 10 8 OHM |
| FR 10 F 4 OHM | FR 10 HM 4 OHM |
| FR 10 HM 8 OHM | FR 10 WP 4 OHM (black) |
| FR 10 WP 4 OHM (white) | FR 10 WPX 4 OHM (black) |
| FR 10 WPX 4 OHM (white) | FRS 10 WP 4 OHM (black) |
| FRS 10 WP 4 OHM (white) | FRS 10 WP 8 OHM (black) |
| FRS 10 WP 8 OHM (white) | R 10 S 4 OHM |
| R 10 S 8 OHM | R 10 SC 4 OHM |

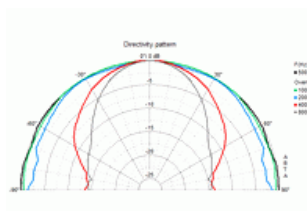

directivity pattern